

PTFE EXPANSION JOINT

PTFE T2

Expansion joint with loose flanges, carbon steel painted.

STANDARD

ASTM D-4895

Flanges: EN 1092-1

MATERIAL

Bellow: white PTFE

Flanges: carbon steel

OTHER SPECIFICATIONS

Pressure class bellow: see pressure resistance table

Flange pattern: DN15-40:PN40

DN50-150: PN16

DN200-500: PN10

ALSO AVAILABLE

- Stainless steel flanges
- Flanges acc. ASME B16.5
- Antistatic (black) PTFE"

POSSIBLE ACCESSORIES

- Always equipped with limiters

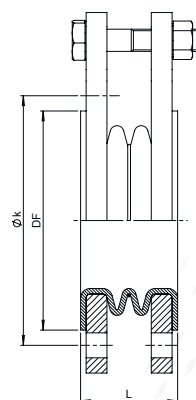

TECHNICAL DATA

| PTFE T2 EXPANSION JOINT | CODE | DN | L mm | DF mm | Øk mm | NOC - | Movements | | | Eff. A cm ² | Spring rate ax. N/mm |
|----------------------------|------|-----|---------|----------|----------|----------|------------|-------------|------------|---------------------------|----------------------------|
| | | | | | | | ± ax mm | ± lat mm | ± ang ° | | |
| KPK015 | 15 | 54 | 45 | 65 | 2 | 6 | 3 | 7 | 24 | 27 | |
| KPK020 | 20 | 54 | 58 | 75 | 2 | 6 | 3 | 7 | 24 | 27 | |
| KPK025 | 25 | 54 | 68 | 85 | 2 | 6 | 3 | 7 | 24 | 27 | |
| KPK032 | 32 | 56 | 78 | 100 | 2 | 6 | 3 | 7 | 33 | 57 | |
| KPK040 | 40 | 56 | 88 | 110 | 2 | 6 | 3 | 7 | 40 | 66 | |
| KPK050 | 50 | 68 | 102 | 125 | 2 | 10 | 3 | 7 | 55 | 86 | |
| KPK065 | 65 | 78 | 122 | 145 | 2 | 12 | 5 | 7 | 85 | 122 | |
| KPK080 | 80 | 88 | 138 | 160 | 2 | 15 | 5 | 7 | 113 | 147 | |
| KPK100 | 100 | 88 | 158 | 180 | 2 | 15 | 6 | 7 | 158 | 161 | |
| KPK125 | 125 | 95 | 188 | 210 | 2 | 15 | 6 | 7 | 222 | 177 | |
| KPK150 | 150 | 105 | 212 | 240 | 2 | 15 | 6 | 7 | 299 | 168 | |
| KPK200 | 200 | 110 | 268 | 295 | 2 | 15 | 6 | 7 | 483 | 185 | |
| KPK250 | 250 | 128 | 320 | 350 | 2 | 20 | 6 | 7 | 731 | 174 | |
| KPK300 | 300 | 140 | 378 | 400 | 2 | 20 | 10 | 7 | 973 | 161 | |

PRESSURE RESISTANCE TABLE (2 CONVOLUTIONS)

| TEMPERATURE | PRESSURE DN15-DN100 | PRESSURE DN125-250 |
|-------------|---------------------|--------------------|
| 20°C | 10 | 10 |
| 50°C | 9,6 | 8,6 |
| 100°C | 8,6 | 7 |
| 125°C | 7,2 | 5,3 |
| 150°C | 5,8 | 3,9 |
| 175°C | 4,5 | 2,7 |
| 200°C | 3,2 | 1,7 |
| 225°C | 1,5 | 0,5 |
| 250°C | 0,5 | 0,2 |